

For Lease

DENNY ELWELL COMPANY
Commercial Real Estate & Development

RETAIL/OFFICE



2120 Ingersoll Ave
Des Moines, Iowa 50312

- 5,496 SF Two Story Building
- Attractive Architectural Design Elements
- High-End Finishes
- Prime Location with Downtown Views
- Excellent Visibility on the Corner of Ingersoll Ave and Martin Luther King Jr. Pkwy
- High Traffic Counts
- Ideal Opportunity for Professional Office, Retail, or Restaurant
- Former Restaurant with Two 5,000-Gallon Grease Interceptors In Place

Contact One of Our Agents for More Information: 515.964.1587



dennyelwellcompany.com
515-964-1587

2401 SE Tones Dr Suite 17 Ankeny, Iowa 50021

The information contained herein is deemed reliable but not guaranteed by Denny Elwell Company
Licensed to sell real estate in the state of Iowa

For Lease

2120 Ingersoll Ave
Des Moines, Iowa 50312



dennyelwellcompany.com
515-964-1587

2401 SE Tones Dr Suite 17 Ankeny, Iowa 50021
The information contained herein is deemed reliable but not
guaranteed by Denny Elwell Company
Licensed to sell real estate in the state of Iowa

For Lease

2120 Ingersoll Ave
Des Moines, Iowa 50312

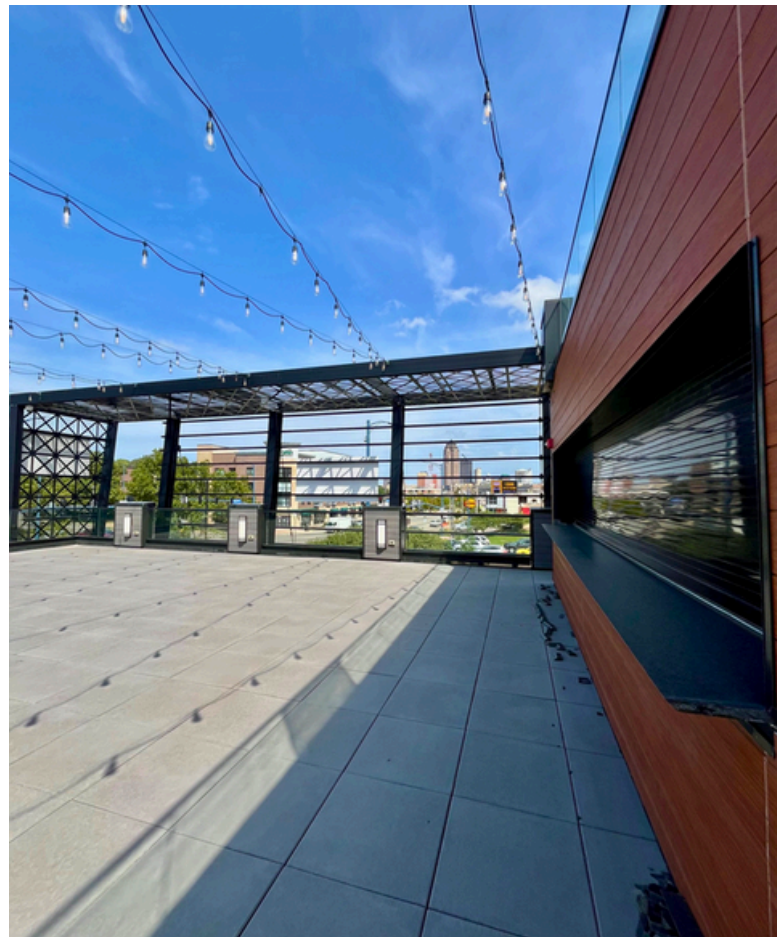

dennyelwellcompany.com
515-964-1587

2401 SE Tones Dr Suite 17 Ankeny, Iowa 50021
The information contained herein is deemed reliable but not
guaranteed by Denny Elwell Company
Licensed to sell real estate in the state of Iowa

For Lease

2120 Ingersoll Ave
Des Moines, Iowa 50312



dennyelwellcompany.com
515-964-1587

2401 SE Tones Dr Suite 17 Ankeny, Iowa 50021
The information contained herein is deemed reliable but not
guaranteed by Denny Elwell Company
Licensed to sell real estate in the state of Iowa

For Lease

2120 Ingersoll Ave Des Moines, Iowa 50312



dennyelwellcompany.com
515-964-1587

2401 SE Tones Dr Suite 17 Ankeny, Iowa 50021
The information contained herein is deemed reliable but not
guaranteed by Denny Elwell Company
Licensed to sell real estate in the state of Iowa

For Lease

2120 Ingersoll Ave
Des Moines, Iowa 50312

Ingersoll Ave

Fun Facts & Historic Highlights

1. Streetscape & "The Avenues" Branding

- What started in 2009 as a small beautification pilot has evolved into a full corridor makeover, featuring wide sidewalks, protected bike lanes, curb extensions, green planter boxes, bike racks, and pedestrian-friendly signals. These enhancements have improved safety and boosted foot traffic along the commercial strip.[City-DataRent.com](#)
- Ingersoll & Grand Avenues have been branded "The Avenues" to emphasize the area's cultural and economic vitality and connect it to the Arts Center and downtown.[We Are Iowa](#)

2. Road Diet: Safer, Slower, Better

- The "road diet" conversion of Ingersoll from four lanes to three (with a center turn lane) cut crashes by 50%, injury crashes by 30%, and vehicle speeds by 10%. It also added over 50 on-street parking spaces and supports more than 200 cyclists daily.[City-Data](#)

3. Historic Streetcar Remnants

- During recent repaving, the city unearthed remnants of a trolley barn and streetcar tracks from Ingersoll Avenue's early 20th-century transit history. The preserved pieces are being donated for historic preservation.[KCCI](#)

Neighborhood Demographics & Lifestyle

Ingersoll Park (surrounding area along the avenue)

- Population: ~774 residents, median age ~42.[Homes.comNiche](#)
- Median household income: ~\$91,300 (2021); average household income: ~\$124,500.[Homes.com](#)
- Education: ~99.6% high school graduates, ~79.8% with a college degree, ~40.5% with advanced degrees.[Homes.comNeighborhoodScout](#)
- Lifestyle & Community: Highly walkable and bikeable, with plenty of cafes, galleries, and parks. Niche ranks it A overall for families, nightlife, jobs, and outdoor activities.[NicheRent.com](#)
- Residents describe Ingersoll Park as safe, friendly, and walkable—"safe, clean, friendly, great schools," and "Ingersoll Live is like a big block party": a neighborhood worth sticking around for![Trulia Real Estate Search](#)

Ingersoll Oaks (adjacent neighborhood in ZIP 50312)

- Small area (~0.027 sq mi) with a population of about 177; very dense at ~6,500 people per square mile.[City-Data](#)
- Median household income: \$138,700—more than double the city average (\$60,900).[City-Data](#)
- Home values span from ~\$200k to over \$750k; wide mix of renters and owners.[City-Data+1](#)

Waterbury/Ingersoll Park (broader neighborhood context)

- Homes rich in historic charm—over 63% of homes built before 1939.[NeighborhoodScout](#)
- Extremely educated community: ~41% hold advanced degrees, higher than ~13.7% nationally.[NeighborhoodScout](#)
- A majority (~72%) are executives, managers, or professionals.[NeighborhoodScout](#)

Zip Code 50312 (estimate around Ingersoll Ave)

- Median age: ~42; population density: ~2,700/sq mi.[Iowa Realty](#)
- College-educated: ~67%; median income: ~\$66,200.[Iowa Realty](#)
- Owner-renter ratio: ~61% owners, 39% renters.[Iowa Realty](#)
- Nearby schools: Hanawalt Elementary, Merrill Middle, Roosevelt High.[Iowa Realty](#)



dennyelwellcompany.com
515-964-1587

2401 SE Tones Dr Suite 17 Ankeny, Iowa 50021

The information contained herein is deemed reliable but not guaranteed by Denny Elwell Company
Licensed to sell real estate in the state of Iowa